



**JØTUL F 370**

## ENJOY THE HEAT FROM A MODERN DESIGN STOVE

The Jøtul F 370 is characterized by a timeless, award-winning design, and it is one of the world's best-selling wood stoves. The combustion chamber is surrounded by glass windows, creating an optimal three-sided fire view. This wood stove is the first and only in the world to have won the prestigious international Red Dot Design Award: Best of the Best.



**JØTUL F 500 OSLO**

**HOT. VERY HOT.**

The Jøtul F 500 Oslo is large enough to heat your entire house during those long cold winter days and nights. With its signature Gothic arch design and large fire viewing area, the Jøtul F 500 Oslo is the best selling large non-catalytic cast iron wood stove sold in North America.



**Quality Cast Iron**

Throughout the years this line of freestanding woodstoves and inserts has earned a reputation for being some of the best on the market for heating properties, quality, and durability.



## JØTUL F 602

Eva Horton, the pioneering importer of Jøtul stoves in North America, shared the warmth of this stove with her neighbors in Maine in the early 1970s. Her early efforts led to Jøtul earning the dominant position in the cast iron hearth industry that it still enjoys today. The Jøtul F 602 CB “Little Giant” is the very definition of classic and comprises half of our Heritage line of wood stoves.

HEATING CAPACITY: Up to 800 sqft  
 MAXIMUM HEAT OUTPUT: Up to 28,000 BTU/hr  
 EFFICIENCY: LHV 70.6% - HHV 76.27%  
 BURN TIME: Up to 5 hrs  
 EMISSIONS: 3.4 grams/hr  
 LOG SIZE: Up to 16”  
 FIREBOX SIZE: .82 ft³  
 WEIGHT APPROX. 160 LBS  
 DIMENSIONS (HXWXD)  
 25 1/4” X 12 5/8” X 21 1/4”  
 MINIMUM HEARTH DIMENSIONS (W X D)  
 28 1/2” x 45 1/2”

ACCESSORIES: Screen, rear heat shield, fresh air kit, stove top thermometer, and stove gloves



## JØTUL F 100 NORDIC QT CF

Showcasing a detailed cast iron pattern based on a traditional Norwegian sweater and offering an unobstructed view of the fire, the Jøtul F 100 Nordic QT CF (clean face) is the perfect space heater for cottages, camps, and smaller living areas. This powerful stove continues our tradition of design and innovation with the Jøtul Simplex™ clean burn technology, which optimizes fire viewing area, fuel loading convenience, and combustion efficiency.

HEATING CAPACITY: Up to 800 sqft  
 MAXIMUM HEAT OUTPUT: Up to 35,000 BTU/hr  
 EFFICIENCY: LHV 78.75% - HHV 72.85%  
 BURN TIME: Up to 6 hrs  
 EMISSIONS: 3.0 grams/hr  
 LOG SIZE : Up to 16”  
 FIREBOX SIZE: .85 ft³  
 WEIGHT APPROX. 215 lbs  
 DIMENSIONS (HXWXD)  
 22 1/2” X 20 3/4” X 14”  
 MINIMUM HEARTH DIMENSIONS (W X D)  
 37” x 38”

ACCESSORIES: Flue collar heatshield, long leg kit, leg leveler kit, fresh air kit, stove top thermometer, and stove gloves





## JØTUL F 3 CB

The Jøtul F 3 CB is the world's best value for your heating dollar and remains the best selling small cast iron wood stove in North America. Selling up to 20,000 stoves worldwide each year, the Jøtul F 3 CB has an impeccable track record for durability - as do all of our stoves.

HEATING CAPACITY: Up to 1,200 sqft  
 MAXIMUM HEAT OUTPUT: Up to 42,000 BTU/hr  
 EFFICIENCY: LHV 78.71% - HHV 72.79%  
 BURN TIME: Up to 7 hrs  
 EMISSIONS: 3.78 grams/hr  
 LOG SIZE: Up to 18"  
 FIREBOX SIZE: 1.17 ft<sup>3</sup>  
 WEIGHT APPROX: 265 lbs  
 DIMENSIONS (HXWXD)  
 28" X 22 7/8" X 14 3/4"  
 MINIMUM HEARTH DIMENSIONS (W X D)  
 39" x 39"

ACCESSORIES: Screen, short leg kit, leg leveler kit, fresh air kit, stove top thermometer, and stove gloves

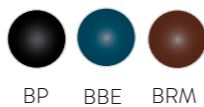

## JØTUL F 400 CASTINE

Handsomely detailed in cast iron, the F 400 Castine's nautical styling recalls the coves and shores locked amid the rocks and pines of Maine. Featuring meticulous craftsmanship and practical design, the Jøtul F 400 Castine will provide a warm, wonderful centerpiece for your hearth and home.

HEATING CAPACITY: Up to 1,500 sqft  
 MAXIMUM HEAT OUTPUT: Up to 55,000 BTU/hr  
 EFFICIENCY: LHV 73.78% - HHV 68.29%  
 BURN TIME: Up to 8 hrs  
 EMISSIONS: 3.77 grams/hr  
 LOG SIZE: Up to 20"  
 FIREBOX SIZE: 1.77 ft<sup>3</sup>  
 WEIGHT APPROX: 375 lbs  
 DIMENSIONS (HXWXD)  
 28 1/2" X 25 3/4" X 18 1/2"  
 MINIMUM HEARTH DIMENSIONS (W X D)  
 42" x 44"

ACCESSORIES: Screen, short leg kit, rear heatshield, leg leveler kit, outside air kit, stove top thermometer, and stove gloves

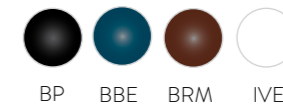



## JØTUL F 400 CASTINE CF

Jøtul's medium-sized single door, non-catalytic woodstove just got better, with an unobstructed fire-view and air wash performance. Featuring meticulous craftsmanship and practical design, the Jøtul F 400 Castine CF (clean face) will provide a warm, wonderful centerpiece for your hearth and home.

HEATING CAPACITY: Up to 1,500 sqft  
 MAXIMUM HEAT OUTPUT: Up to 55,000 BTU/hr  
 EFFICIENCY: LHV 73.78% - HHV 68.29%  
 BURN TIME: Up to 8 hrs  
 EMISSIONS: 3.77 grams/hr  
 LOG SIZE: Up to 20"  
 FIREBOX SIZE: 1.77 ft<sup>3</sup>  
 WEIGHT APPROX: 375 lbs  
 DIMENSIONS (HXWXD)  
 28 1/2" X 25 3/4" X 18 1/2"  
 MINIMUM HEARTH DIMENSIONS (W X D)  
 42" X 44"

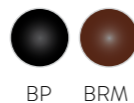

ACCESSORIES: Screen, short leg kit, rear heatshield, leg leveler kit, outside air kit, stove top thermometer, and stove gloves



## JØTUL F 118 CB BLACK BEAR

The Jøtul F 118 CB Black Bear is a timeless classic which has been updated with clean-burn technology and new details. The front of the wood stove is decorated with an ancient Norwegian prayer that was believed to keep the fire lit and the dark forces away from the house.

HEATING CAPACITY: Up to 1,500 sqft  
 MAXIMUM HEAT OUTPUT: Up to 55,000 BTU/hr  
 EFFICIENCY: LHV 78.86% - HHV 72.94%  
 BURN TIME: Up to 8 hrs  
 EMISSIONS: 3.43 grams/hr  
 LOG SIZE: Up to 24"  
 FIREBOX SIZE: 1.47 ft<sup>3</sup>  
 WEIGHT APPROX: 340 lbs  
 DIMENSIONS (HXWXD)  
 30 1/2" X 14" X 29 3/8"  
 MINIMUM HEARTH DIMENSIONS (W X D)  
 30 1/2" X 53"



ACCESSORIES: Screen, side and rear heatshield, fresh air kit, stove top thermometer, and stove gloves



## JØTUL F 500 OSLO

Jøtul has taken great pride in redesigning their most popular wood stove, the F 500 Oslo. Without sacrificing function over form, Jøtul has managed to keep all the technical aspects of the F 500 Oslo while modernizing the look. A minimal arched front now creates an even larger, less cluttered fire view, while the same minimalist design to the sides, ashpan and top striking the perfect balance between contemporary style and classic arches. The Jøtul F 500 Oslo wood stove features both front and left side-loading convenience, plus its legendary non-catalytic clean burn combustion efficiency.

HEATING CAPACITY: Up to 2,000 sqft  
 MAXIMUM HEAT OUTPUT: Up to 70,000 BTU/hr  
 EFFICIENCY: LHV 79.88% - HHV 73.94%  
 BURN TIME: Up to 9 hrs  
 EMISSIONS: 3.2 grams/hr  
 LOG SIZE: Up to 24"  
 FIREBOX SIZE: 2.54 ft<sup>3</sup>  
 WEIGHT APPROX: 445 lbs  
 DIMENSIONS (HXWXD)  
 28 1/2" X 28 1/4" X 22 1/2"  
 MINIMUM HEARTH DIMENSIONS (W X D)  
 54 1/2" x 50 1/2"

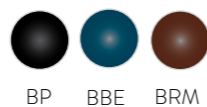

ACCESSORIES: Cookplate, blower fan kit, screen, rear heatshield, leg leveler kit, outside air kit, stove top thermometer, short leg kit, and stove gloves

## JØTUL F 500 OSLO CF

Showcasing all the features and benefits of our new redesigned Jøtul F 500 Oslo including front and left side loading capabilities, the Jøtul F 500 Oslo CF (clean face) now offers an unobstructed view of the fire as well.

HEATING CAPACITY: Up to 2,000 sqft  
 MAXIMUM HEAT OUTPUT: Up to 70,000 BTU/hr  
 EFFICIENCY: LHV 79.88% - HHV 73.94%  
 BURN TIME: Up to 9 hrs  
 EMISSIONS: 3.2 grams/hr  
 LOG SIZE: Up to 24"  
 FIREBOX SIZE: 2.54 ft<sup>3</sup>  
 WEIGHT APPROX: 445 lbs  
 DIMENSIONS (HXWXD)  
 28 1/2" X 28 1/4" X 22 1/2"  
 MINIMUM HEARTH DIMENSIONS (W X D)  
 54 1/2" x 50 1/2"

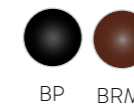

ACCESSORIES: Cookplate, blower fan kit, screen, rear heatshield, leg leveler kit, outside air kit, stove top thermometer, short leg kit, and stove gloves



## JØTUL F 600 FIRELIGHT CB

This extra large woodstove has long been one of our signature stoves, showcasing our design prowess. Durably built and superbly crafted, the Jøtul F 600 Firelight CB offers both front and right side-loading convenience in a classic design inspired by colonial American furniture.

HEATING CAPACITY: Up to 2,200 sqft  
 MAXIMUM HEAT OUTPUT: Up to 81,500 BTU/hr  
 EFFICIENCY: LHV 80.16% - HHV 74.18%  
 BURN TIME: Up to 9 hrs  
 EMISSIONS: 4.1 grams/hr  
 LOG SIZE: Up to 24"  
 FIREBOX SIZE: 2.97 ft<sup>3</sup>  
 WEIGHT APPROX: 465 lbs  
 DIMENSIONS (HXWXD)  
 31" X 29" X 21 1/2"  
 MINIMUM HEARTH DIMENSIONS (W X D)  
 55" x 50"

ACCESSORIES: Blower fan kit, screen, rear heatshield, leg leveler kit, outside air kit, stove top thermometer, and stove gloves



BP



## JØTUL F 370

A modern addition to our woodstove line, the Jøtul F 370 showcases innovative features and modern design details. Featuring the industry's first convex triangular cast iron construction and a unique glass panel design, the Jøtul F 370's elegant three-sided fireview will be the focal point of any room.

HEATING CAPACITY: Up to 800 sqft  
 MAXIMUM HEAT OUTPUT: Up to 35,000 BTU/hr  
 EFFICIENCY: LHV 71.19% - HHV 65.86%  
 BURN TIME: Up to 5 hrs  
 EMISSIONS: 2.6 grams/hr  
 LOG SIZE: Up to 12"  
 FIREBOX SIZE: 1.25 ft<sup>3</sup>  
 WEIGHT APPROX: 344 lbs  
 DIMENSIONS (HXWXD)  
 45 1/2" X 17 1/2" X 18 5/8"  
 MINIMUM HEARTH DIMENSIONS (W X D)  
 29 1/2" x 33 3/4"

ACCESSORIES: stove top thermometer and stove gloves



BP

## JØTUL F 50 TL RANGELEY

# TOP LOADING CONVENIENCE

Jøtul's signature cast iron and steel stove, the Jøtul F 50 TL Rangeley, paved the way for what would become Jøtul's line of convection/radiant stoves. Utilizing Jøtul's patented rotating baffle, the Jøtul F 50 TL Rangeley can be easily loaded from the top with the turn of a handle.







## JØTUL F 45 GREENVILLE

Immense heat from a medium size stove, the Jøtul F 45 Greenville is the perfect heater for those cold winter nights.

HEATING CAPACITY: Up to 1,500 sqft  
 MAXIMUM HEAT OUTPUT: Up to 55,000 BTU/hr  
 EFFICIENCY: LHV 80.10% - HHV 74.15%  
 BURN TIME: Up to 8 hrs  
 EMISSIONS: 2.31 grams/hr  
 LOG SIZE: Up to 18" (front to back)  
 FIREBOX SIZE: 2.3 ft<sup>3</sup>  
 WEIGHT APPROX. 445 lbs  
 DIMENSIONS (HXWXD):  
 29 3/4" x 22 3/4" x 25 7/8"  
 MINIMUM HEARTH DIMENSIONS (W X D)  
 30" x 44"

ACCESSORIES: Fire screen, steel short leg kit (for fireplace installation only), blower fan kit, stove top thermometer, outside air kit, and stove gloves



BP



## JØTUL F 55 CARRABASSETT

If you are looking for a whole house heater, look no further. The Jøtul F 55 Carrabassett is large enough to be used as a primary heat source and commands up to 10 hours of burn time.

HEATING CAPACITY: Up to 2,300 sqft  
 MAXIMUM HEAT OUTPUT: Up to 83,000 BTU/hr  
 EFFICIENCY: LHV 82.37% - HHV 76.23%  
 BURN TIME: Up to 10 hrs  
 EMISSIONS: 3.50 grams/hr  
 LOG SIZE: Up to 18" (front to back)  
 FIREBOX SIZE: 2.95 ft<sup>3</sup>  
 WEIGHT APPROX. 475 LBS  
 DIMENSIONS (HXWXD):  
 30 5/8" x 27 1/4" x 24 1/2"  
 MINIMUM HEARTH DIMENSIONS (W X D)  
 33" x 40 3/4"

ACCESSORIES: Fire screen, blower fan kit, stove top thermometer, outside air kit, and stove gloves



BP

## JØTUL TOP LOADING TECHNOLOGY



Utilizing Jøtul's patented rotating baffle, the Jøtul F 50 TL Rangeley can be easily loaded from the top with the turn of a handle.

## JØTUL WINTERGRILL



Turning your Jøtul F 50 TL Rangeley into a fully functioning grill or smoker is quick and easy. Drop in the stainless steel grill, close the top, and get ready to enjoy grilled food any time of the year.



“WHO SAYS THE GRILLING SEASON  
HAS TO END ON LABOR DAY?”

## JØTUL F 50 TL RANGELEY

Leading the way in clean combustion technology, Jøtul now offers the convenience of top-loading in a non-catalytic wood stove. Utilizing Jøtul's patented rotating baffle, the Jøtul F 50 TL Rangeley can be easily loaded from the top with the turn of a handle.

HEATING CAPACITY: Up to 2,300 sqft  
 MAXIMUM HEAT OUTPUT: Up to 83,000 BTU/hr  
 EFFICIENCY: LHV 77.76% - HHV 71.91%  
 BURN TIME: Up to 8 hrs  
 EMISSIONS: 2.84 grams/hr  
 LOG SIZE: Up to 20"  
 FIREBOX SIZE: 2.67 ft<sup>3</sup>  
 WEIGHT APPROX: 569 lbs  
 DIMENSIONS (HXWXD):  
 30 5/8" x 27 1/4" x 24 1/2"  
 MINIMUM HEARTH DIMENSIONS (W X D)  
 33" x 40 3/4"

ACCESSORIES: WinterGrill™ kit, fire screen, blower fan kit, stove top thermometer, outside air kit and stove gloves



BP



**JØTUL C 550 ROCKLAND CB**

## FLUSH FACE FIREPLACE INSERT

Clean lines and delicate curves frame the magnificent fire view of our large flush face wood burning insert - the Jøtul C 550 Rockland CB. Featuring one of the largest fire viewing areas of any comparably sized wood burning insert, the Jøtul C 550 Rockland CB maximizes heating efficiency and firebox capacity.



## JØTUL C 350 WINTERPORT



Jøtul C 350 Winterport standard cast iron surround (37" W x 25 1/4" H) with 2" cast iron plinth (37" W x 27 1/4" H)



Jøtul C 350 Winterport with steel wide trim kit (40" W x 30" H)



Jøtul C 350 Winterport with trimable steel surround (37" W x 25 1/2" H)

Designed specifically for smaller masonry fireplaces and factory built wood fireplaces, the Vesta Design and Technology Award-winning Jøtul C 350 Winterport is our latest innovation in wood insert technology.

HEATING CAPACITY: Up to 1,200 sqft  
 MAXIMUM HEAT OUTPUT: Up to 40,000 BTU/hr  
 EFFICIENCY: LHV 80.20% - HHV 74.20%  
 BURN TIME: Up to 7 hrs.  
 EMISSIONS: 4.0 grams/hr  
 LOG SIZE: Up to 20"  
 FIREBOX SIZE: 1.32 ft<sup>3</sup>  
 WEIGHT APPROX: 425 lbs  
 MINIMUM FIREPLACE DIMENSIONS (W x H x D)  
 32" x 19 1/2" x 16"  
 MINIMUM HEARTH DIMENSIONS (W x D)  
 34 1/2" x 16"

ACCESSORIES: Steel wide trim surround, trimable steel surround, and stove gloves



BP



## JØTUL C 450 KENNEBEC CF



Jøtul C 450 Kennebec CF cast iron surround (40" W x 30 1/4" H)



Jøtul C 450 Kennebec CF with steel wide trim kit (47 3/4" W x 34" H)



Jøtul C 450 Kennebec CF with trimable steel surround (40" W x 30" H)

The Jøtul C 450 Kennebec CF (clean face) is a medium sized wood insert with a large glass area providing a perfect view of the burning logs. Able to take a log up to 20", the Jøtul C 450 Kennebec is the perfect heater for your hearth and home.

HEATING CAPACITY: Up to 1,400 sqft  
 MAXIMUM HEAT OUTPUT: Up to 50,000 BTU/hr  
 EFFICIENCY: LHV 78.42% - HHV 72.54%  
 BURN TIME: Up to 8 hrs.  
 EMISSIONS: 4.4 grams/hr  
 LOG SIZE: Up to 20"  
 FIREBOX SIZE: 2.05 ft<sup>3</sup>  
 WEIGHT APPROX: 445 lbs  
 MINIMUM FIREPLACE DIMENSIONS (W x H x D)  
 27 1/2" x 23" x 14-17"  
 MINIMUM HEARTH DIMENSIONS (W x D)  
 40" x 18"

ACCESSORIES: Outside air kit, steel wide trim surround, trimable steel surround, mantel heatshield, and stove gloves



BP

**NOW WITH  
 IMPROVED CLEARANCES!**



## JØTUL C 550 ROCKLAND CB



Jøtul C 550 Rockland CB cast iron surround  
(40" W x 31 5/8" H)



Jøtul C 550 Rockland CB with steel wide trim kit (44" W x 34" H)



Jøtul C 550 Rockland CB with trimable steel surround (40" W x 32" H)

Clean lines and delicate curves frame the magnificent fire view of our large flush face wood burning insert – the Jøtul C 550 Rockland CB. Named after the coastal Maine town of Rockland, the Jøtul C 550 CB is designed to be a whole house heater.

HEATING CAPACITY: Up to 1,700 sqft  
 MAXIMUM HEAT OUTPUT: Up to 65,000 BTU/hr  
 EFFICIENCY: LHV 77.28% - HHV 71.48%  
 BURN TIME: Up to 9 hrs.  
 EMISSIONS: 4.5 grams/hr  
 LOG SIZE: Up to 24"  
 FIREBOX SIZE: 2.08 ft<sup>3</sup>  
 WEIGHT APPROX: 550 lbs  
 MINIMUM FIREPLACE DIMENSIONS (W x H x D)  
 33" x 23 3/4" x 18"  
 MINIMUM HEARTH DIMENSIONS (W x D)  
 37" x 16"

ACCESSORIES: Steel wide trim surround, trimable steel surround, and stove gloves



BP



## JØTUL C 550 ROCKLAND CB CF



Jøtul C 550 Rockland CB CF cast iron surround  
(40" W x 31 5/8" H)



Jøtul C 550 Rockland CB CF with steel wide trim kit (44" W x 34" H)



Jøtul C 550 Rockland CB CF with trimable steel surround (40" W x 32" H)

Showcasing all the features and benefits of the traditional Jøtul C 550 Rockland CB, the new Jøtul C 550 Rockland CB CF (clean face) now offers an unobstructed view of the fire as well.

HEATING CAPACITY: Up to 1,700 sqft  
 MAXIMUM HEAT OUTPUT: Up to 65,000 BTU/hr  
 EFFICIENCY: LHV 77.28% - HHV 71.48%  
 BURN TIME: Up to 9 hrs.  
 EMISSIONS: 4.5 grams/hr  
 LOG SIZE: Up to 24"  
 FIREBOX SIZE: 2.08 ft<sup>3</sup>  
 WEIGHT APPROX: 550 lbs  
 MINIMUM FIREPLACE DIMENSIONS: (W x H x D)  
 33" x 23 3/4" x 18"  
 MINIMUM HEARTH DIMENSIONS (W x D)  
 37" x 16"

ACCESSORIES: Steel wide trim surround, trimable steel surround, and stove gloves



BP BRM

# TECHNICAL DIMENSIONS

## JØTUL F 602 CB - Page 8



Heating Capacity	Up to 800 sq. ft.
Max Heat Output	28,000 BTU/hr
Log Size	Up to 16"
Emissions	3.4 Grams/hr
Burn Time	Up to 5 hrs
Firebox Size	.82 ft <sup>3</sup>
Weight	160 lbs
Clearances Top Vent	
Rear	13 1/2"
Side	21"
Corner	13"
Clearances with rear heatshield & double wall chimney connector	
Rear	9"
Side	24"
Corner	9"
Height to top of flue	
Top (26 1/2") Rear (24 3/4")	
Minimum Hearth Dimensions (W x D)	28 1/2" x 45 1/2"

## JØTUL F 3 CB - Page 10

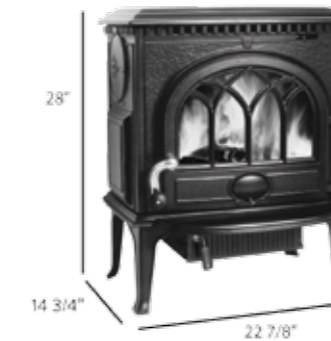

Heating Capacity	Up to 1,200 sq. ft.
Max Heat Output	42,000 BTU/hr
Log Size	Up to 18"
Emissions	3.78 Grams/hr
Burn Time	Up to 7 hrs
Firebox Size	1.17 ft <sup>3</sup>
Weight	265 lbs
Clearances Top Vent	
Rear	25"
Side	24"
Corner	18"
Clearances with rear heatshield & double wall chimney connector	
Rear	10"
Side	18"
Corner	14"
Height to top of flue	
Top (28") Rear (25 1/2") Rear w/opt short leg (23 1/4")	
Minimum Hearth Dimensions (W x D)	39" x 39"

## JØTUL F 100 NORDIC QT - Page 9



Heating Capacity	Up to 800 sq. ft.
Max Heat Output	35,000 BTU/hr
Log Size	Up to 16"
Emissions	3.0 Grams/hr
Burn Time	Up to 6 hrs
Firebox Size	.85 ft <sup>3</sup>
Weight	215 lbs
Clearances Top Vent	
Rear	11"
Side	15"
Corner	10"
Clearances with rear heatshield & double wall chimney connector	
Rear	8"
Side	17"
Corner	10"
Height to top of flue	
Top (24") Rear (21 3/4")	
Minimum Hearth Dimensions (W x D)	37" x 38"

## JØTUL F 400 CASTINE - Page 11/12



Heating Capacity	Up to 1,500 sq. ft.
Max Heat Output	55,000 BTU/hr
Log Size	Up to 20"
Emissions	3.77 Grams/hr
Burn Time	Up to 8 hrs
Firebox Size	1.77 ft <sup>3</sup>
Weight	375 lbs
Clearances Top Vent	
Rear	25"
Side	19"
Corner	18"
Clearances with rear heatshield & double wall chimney connector	
Rear	7"
Side	15"
Corner	11"
Height to top of flue	
Top (29 1/2") Rear (28 1/2") Rear w/opt short leg (26 1/4")	
Minimum Hearth Dimensions (W x D)	42" x 44"

## JØTUL F 370 - Page 17



Heating Capacity	Up to 800 sq. ft.
Max Heat Output	35,000 BTU/hr
Log Size	Up to 12"
Emissions	2.6 Grams/hr
Burn Time	Up to 5 hrs
Firebox Size	1.25 ft <sup>3</sup>
Weight	344 lbs
Clearances Top Vent	
Rear	12"
Side	22"
Corner	16"
Clearances with double wall chimney connector	
Rear	6"
Side	22"
Corner	16"
Height to top of flue	
Top (45") Rear (43 1/2")	
Minimum Hearth Dimensions (W x D)	29 1/2" x 33 3/4"

## JØTUL F 118 CB BLACK BEAR - Page 13



Heating Capacity	Up to 1,500 sq. ft.
Max Heat Output	55,000 BTU/hr
Log Size	Up to 24"
Emissions	3.00 Grams/hr
Burn Time	Up to 8 hrs
Firebox Size	1.47 ft <sup>3</sup>
Weight	340 lbs
Clearances Top Vent	
Rear	9"
Side	35"
Corner	26"
Clearances with rear heatshield & double wall chimney connector	
Rear	3 1/2"
Side	18"
Corner	12 1/2"
Height to top of flue	
Top (32") Rear (30")	
Minimum Hearth Dimensions (W x D)	30 1/2" x 53"

Jøtul wood stoves and inserts efficiencies have been EPA tested and certified. HHV value represents a calculation where the water product in the combustion gas is considered in the liquid form while the LHV is calculated with the water product considered in the vapor form. Simply put, HHV assumes all the water component is in a liquid state (condensed) at the end of combustion and that heat recovered from that condensation can be put to use. With that considered the efficiency value for HHV will be lower due to a higher quantity of energy to be considered relative to the appliances measured temperature release. The maximum heat output value is derived from the certification test data and represents a refueling cycle more representative of homeowner usage than that prescribed by the test protocol. The maximum heating efficiency of XX% (either HHV or LHV) was achieved at a burn rate of XXXXX Btu/hr. This value is a component of the weighted average efficiency calculation.

JØTUL F 500 OSLO - Page 14/15

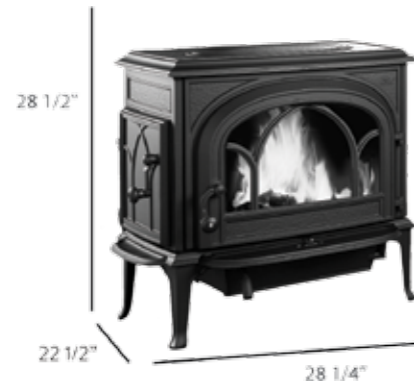

Heating Capacity	Up to 2,000 sq. ft.
Max Heat Output	70,000 BTU/hr
Log Size	Up to 24"
Emissions	3.2 Grams/hr
Burn Time	Up to 9 hrs
Firebox Size	2.54 ft <sup>3</sup>
Weight	445 lbs
Clearances Top Vent	
Rear	18"
Side	14"
Corner	13"
Clearances with rear heatshield & double wall chimney connector	
Rear	6"
Side	14"
Corner	9"
Height to top of flue	
Top (28 1/2")	Rear (28 1/4")
Rear w/opt short legs (26")	
Minimum Hearth Dimensions	54 1/2" x 50 1/2"

JØTUL F 55 CARRABASSETT - Page 21

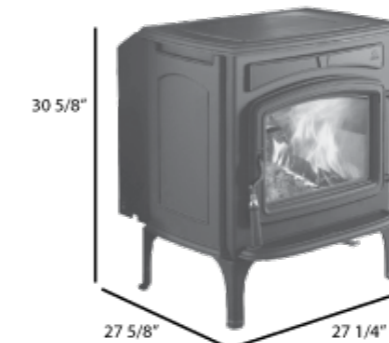

Heating Capacity <sup>1</sup>	Up to 2,300 sq. ft.
Max Heat Output	83,000 BTU/hr
Log Size	Up to 18" front to back
Emissions	3.50 Grams/hr
Burn Time	Up to 10 hrs
Firebox Size	2.95 ft <sup>3</sup>
Weight	475 lbs
Clearances Top Vent	
Rear	10" w/FCHS
Side	14"
Corner	12"
Clearances with rear heatshield & double wall chimney connector	
Rear	6"
Side	14"
Corner	12"
Height to top of flue	
Top (30 5/8")	Rear (30")
Minimum Hearth Dimensions (W x D)	33" x 40 3/4"

JØTUL F 600 FIRELIGHT CB - Page 16



Heating Capacity <sup>1</sup>	Up to 2,200 sq. ft.
Max Heat Output	81,500 BTU/hr
Log Size	Up to 24"
Emissions	4.1 Grams/hr
Burn Time	Up to 9 hrs
Firebox Size	2.97 ft <sup>3</sup>
Weight	465 lbs
Clearances Top Vent	
Rear	19"
Side	13"
Corner	13"
Clearances with rear heatshield & double wall chimney connector	
Rear	8"
Side	13"
Corner	9"
Height to top of flue	
Top (31 1/2")	Rear (30 1/2")
Minimum Hearth Dimensions (W x D)	55" x 50"

JØTUL F 50 TL RANGELEY - Page 23



Heating Capacity <sup>1</sup>	Up to 2,300 sq. ft.
Max Heat Output	83,000 BTU/hr
Log Size	Up to 20"
Emissions	2.84 Grams/hr
Burn Time	Up to 8 hrs
Firebox Size	2.67 ft <sup>3</sup>
Weight	569 lbs
Clearances Top Vent	
Rear	10" w/FCHS
Side	14"
Corner	12"
Clearances with rear heatshield & double wall chimney connector	
Rear	6"
Side	14"
Corner	12"
Height to top of flue	
Top (30 5/8")	Rear (30")
Minimum Hearth Dimensions	33" x 40 3/4"

JØTUL F 45 GREENVILLE - Page 20



Heating Capacity <sup>1</sup>	Up to 1,500 sq. ft.
Max Heat Output	55,000 BTU/hr
Log Size	Up to 18"
Emissions	2.31 Grams/hr
Burn Time	Up to 8 hrs
Firebox Size	2.3 ft <sup>3</sup>
Weight	445 lbs
Clearances Top Vent	
Rear	10" w FCCHS and 16" w/o FCCHS
Side	15"
Corner	11"
Clearances with rear heatshield & double wall chimney connector	
Rear	6"
Side	15"
Corner	11"
Height to top of flue	
Top (29 3/4")	Rear (29 1/2") rear w/opt short legs (26 1/4")
Minimum Hearth Dimensions (W x D)	30" x 44"

JØTUL C 350 WINTERPORT - Page 26

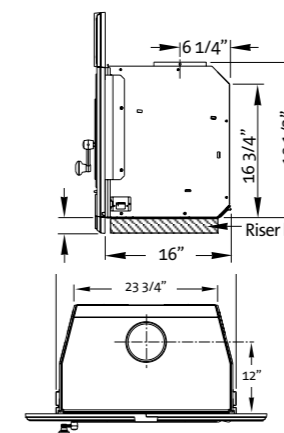

Heating Capacity <sup>1</sup>	Up to 1,200 sq. ft.
Max Heat Output	40,000 BTU/hr
Log Size	Up to 20"
Emissions	4.0 Grams/hr
Burn Time	Up to 7 hrs
Firebox Size	1.32 ft <sup>3</sup>
Weight	425 lbs
Minimum Hearth Dimensions (WxD)	34 1/2" x 16"
Minimum Fireplace Dimensions (WxHxD)	32" x 19 1/2" x 16"
Jøtul C 350 Winterport Classic Cast Iron Surround	37" wide x 25 1/4" high (27 1/4" High w/plinth)
Trimable Steel Surround	37" wide x 25 1/2" high
Steel Wide Trim Kit	40" wide x 30" high

# TECHNICAL DIMENSIONS

## JØTUL C 450 KENNEBEC - Page 27

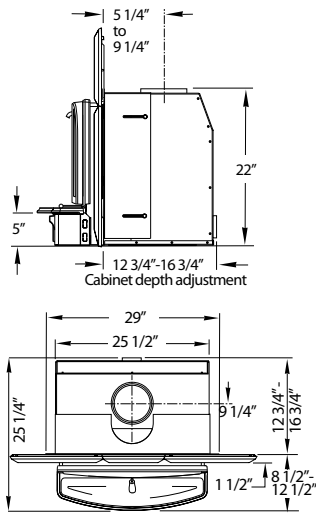

- Heating Capacity<sup>1</sup> Up to 1,400 sq. ft.
- Max Heat Output 50,000 BTU/hr
- Log Size Up to 20"
- Emissions 4.4 Grams/hr
- Burn Time Up to 8 hrs
- Firebox Size 2.05 ft<sup>3</sup>
- Weight 445 lbs
- Minimum Hearth Dimensions (WxD) 40" x 18"
- Minimum Fireplace Dimensions (WxHxD) 27 1/2" x 23" x 14-17" (29" to edge of surround hanger bracket)
- Jøtul C 450 Kennebec Classic Cast Iron Surround 40" wide x 30 1/4" high
- Trimable Steel Surround 40" wide x 30" high
- Steel Wide Trim Kit 47.75" wide x 34" high

## JØTUL C 550 ROCKLAND- Page 28/29

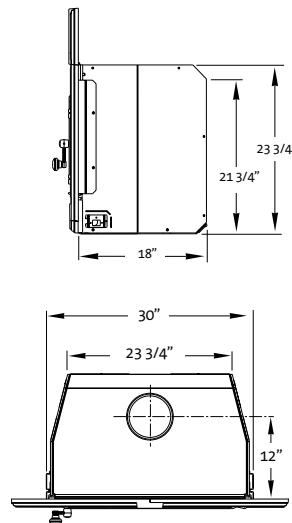

- Heating Capacity<sup>1</sup> Up to 1,700 sq. ft.
- Max Heat Output 65,000 BTU/hr
- Log Size Up to 24"
- Emissions 4.5 Grams/hr
- Burn Time Up to 9 hrs
- Firebox Size 2.08 ft<sup>3</sup>
- Weight 550 lbs
- Minimum Hearth Dimensions (WxD) 37" x 16"
- Minimum Fireplace Dimensions (WxHxD) 33" x 23 3/4" x 18"
- Jøtul C 550 Rockland Classic Cast Iron Surround 40" wide x 31 5/8" high
- Trimable Steel Surround 40" wide x 32" high
- Steel Wide Trim Kit 44" wide x 34" high

## WOOD FIREPLACE INSERT CLEARANCES

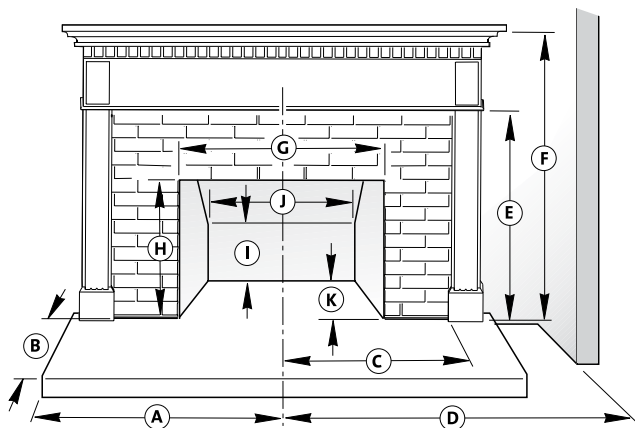

Minimum Dimensions	Jøtul C 350	Jøtul C 450	Jøtul C 550
A: Hearth Width from centerline	17 1/4"	20"	18 1/2"
B: Hearth Depth	16"	18"	16"/20" CAN**
C: To 1" Side Trim from centerline	19 1/2"	22"-27"	(1" to 6") - 23"
D: To Side Wall from centerline	54 1/2"	27"	28"
E: To 1" Top Trim	39"	n/a	39"
F: To 3 1/2" Mantel	48"	39" <sup>1</sup>	40"
To 11 1/2" Mantel	54"	45" <sup>1</sup>	46"
G: Front Opening Width	32"	27 1/2"	33"
H: Lintel Height	19 1/2"	23"	23 3/4"
I: Rear Wall Height	16 3/4"	21 1/2"	22"
J: Rear Wall Width	22 3/4"	25 1/2"	24"
K: Fireplace Depth	16"	14" - 17"	18"

<sup>\*</sup> Add 2" w/ Jøtul C 350 Riser  
<sup>\*\*</sup> Mantel clearance may be reduced by 3" with use of optional Mantel Heat Shield  
<sup>\*\*\*</sup> 15 1/2" in Canada with 2 1/2" raised hearth extension in code approved masonry fireplace  
<sup>1</sup> Mantel clearance may be reduced by 5" in both US and Canada with use of optional Mantel Heat Shield