



hwam N.A.

Wood Stoves & Fireplaces
Made in Denmark

Welcome to HWAM North America

Our goal is to bring International Class hearth products to our customers in North America.

We have selected these products for their superior design, functionality, reliability, and craftsmanship. We also believe that using these products will help minimize our impact on the environment.

In this catalog, we are proud to present wood stoves and fireplaces designed and manufactured in Denmark.

Designers:



Strand + Hvass

In 2005, the design team of Strand + Hvass contributed an absolutely new innovative design series to the HWAM product line, notably the HWAM 3310, HWAM 3320, and HWAM 4410 stoves, including the 3055 series that you will find in this catalog.

Strand + Hvass specialize in industrial furniture design in a classic Danish/Scandinavian style that is characterized by simple clean lines and functional form.

Strand + Hvass have won several design awards, which included designing a chair for Crown Prince Frederik of Denmark in 2002, and "Le prix de l'esthétique" in Paris in 2003 for the "Menuet" chair.

Anders C. FASTERHOLDT

Since the very beginning of HWAM, architect Anders C. FASTERHOLDT has been a regular, highly committed design partner. He is the designer of the Monet series as well as the Classic 7, both of which you will find in this catalog.

Anders C. FASTERHOLDT was originally a cabinetmaker and furniture designer, so he has always thought of a stove as a piece of furniture that provides warmth, and therefore develops stoves based on this idea. In addition to the fact that he has influenced us with his professional design expertise, Anders' basic philosophy is, "Function before all," which means that he is deeply involved in the development of combustion technology before ever completing a design.



"For my part, function is the most important thing. I have always said: Function first, and the design will appear automatically. The idea of designing for its own sake is not my field."

~ Anders C. FASTERHOLDT

"Anders' work has characterized HWAM throughout the 30 years we have been developing stoves, and in a way that we are extremely grateful for."

~ Vagn Hvam Pedersen

Design

Since HWAM was founded 40 years ago we have continued the Danish tradition of partnership between internationally accomplished designers and manufacturing. It is no coincidence that HWAM stoves and fireplaces are known as “*heating furniture*.” They are designed by architects to fit beautifully and functionally in your home. Some of HWAM’s notable design features are: an elevated firebox that can be seen throughout the room, small footprint, close clearances to combustibles and above all, a sleek and subtle form.

Fit and finish

Fit and finish can best be described as how a product feels when you move your hand over it, and how the moving parts work together. Smooth surfaces and edges and, the way our doors open, close, and latch are just some of the things you will notice when you look closely at a HWAM.

Performance

When you see the flames in a HWAM for the first time it can remind you of a “dance performance” with the flames leaping and twirling. But behind this entrancing beauty is the high performance technology that makes the HWAM combustion chamber work the way it does. The automatic air control system, the large clean glass, and the molded Skamol refractory all work together to make the fire the most beautiful and efficient in the market.

Ease of use

You don’t need to be an experienced wood burner to get the most out of a HWAM stove or fireplace. All of our appliances come equipped with the HWAM Autopilot™. Relax, read a book, socialize, drink a glass of wine. The HWAM takes care of itself. After lighting, there is no need to constantly adjust the air controls.

Proven Track Record

HWAM has been making stoves for 40 years. A 100% family owned, managed, and operated company.

European Quality

HWAM exports about 70% of its production, most of it to Western Europe. Our customers in Germany and Norway are well known for their demands on quality. HWAM fireplaces and stoves are made in Denmark using state of the art technology and HWAM is an ISO certified company.

40 years of Innovation

First wood stove independently tested using the combustion and safety protocols used to test boilers.

First to bring a fireplace insert to market.

First to bring a glass-cleaning air-wash design to market.

First to bring a curved glass door to market.

Patented the HWAM Autopilot™ to automatically control combustion.

First to develop molded vermiculite refractory material in conjunction with Skamol.

First to develop shaped soapstone in conjunction with Tulikivi.

Environmental CO₂ and HWAM's Continuing Commitment

You can light up a HWAM stove with a clear conscience, since burning wood is a CO₂-neutral process, which means that no additional CO₂ is given off to the environment. The CO₂ captured in the wood is simply released again, so the wood gives off the same amount of CO₂ as if it were decomposing on the forest floor. Many years of development work have made HWAM stoves extremely efficient, enabling them to utilize nearly all the energy in the wood. The smoke coming out of the chimney consists mainly of water vapor, resulting in a minimum impact on the environment.

HWAM stoves already meet the rigorous Norwegian environmental standards, among the most restrictive in Europe, on minimizing the amount of hazardous particles and gasses released into the atmosphere. This means that with a HWAM stove you will get a heating source with a very high level of efficiency, low emissions, and which gives you greater amount of environmentally friendly heating for your money.

HWAM is committed to making its stoves even more efficient and environmentally friendly.

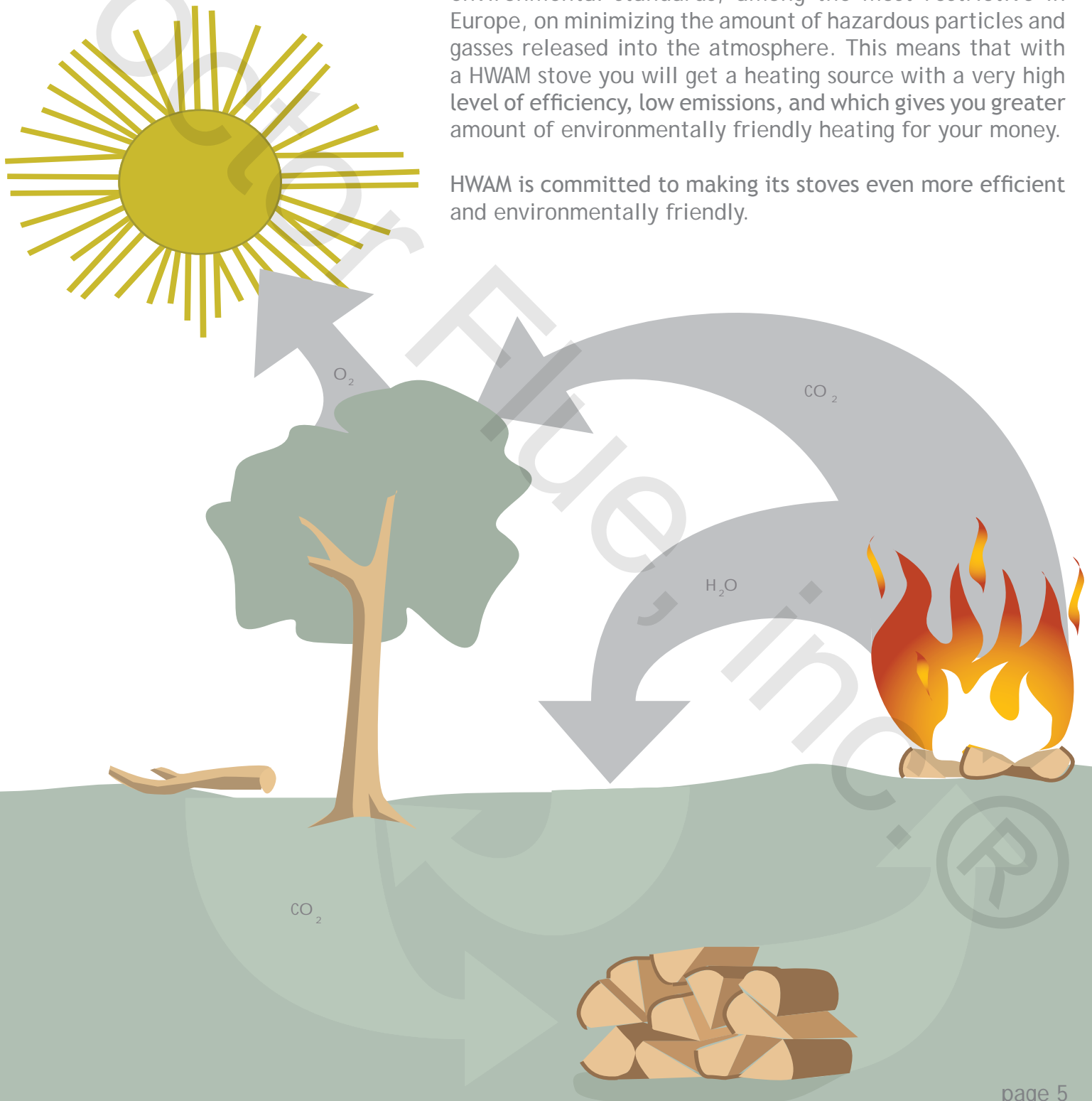

HWAM *Autopilot*TM

What it does

The patented HWAM AutopilotTM controls three sources of the combustion air supply to maximize heat output and efficiency while minimizing harmful emissions.

Benefits

Cleaner combustion - 20% less Carbon Monoxide

= Less impact on the environment and your health

More efficient combustion - up to 30% more efficient

= More heat for your money

= Less wood burned

= Less heat up the chimney - 40% less!

Less soot in the chimney and appliance

= Better fire safety

= Less cleaning and maintenance

Easy operation

= No need to adjust the controls during operation, just, "Set it and forget it."

All modern wood-burning stoves provide adequate, efficient combustion. Unfortunately, not all stove owners know how to operate their wood-burning stoves to the optimum.

Sketches 1 and 2 show the difference between combustion as it occurs when firing with and without HWAM automaticTM combustion optimization.

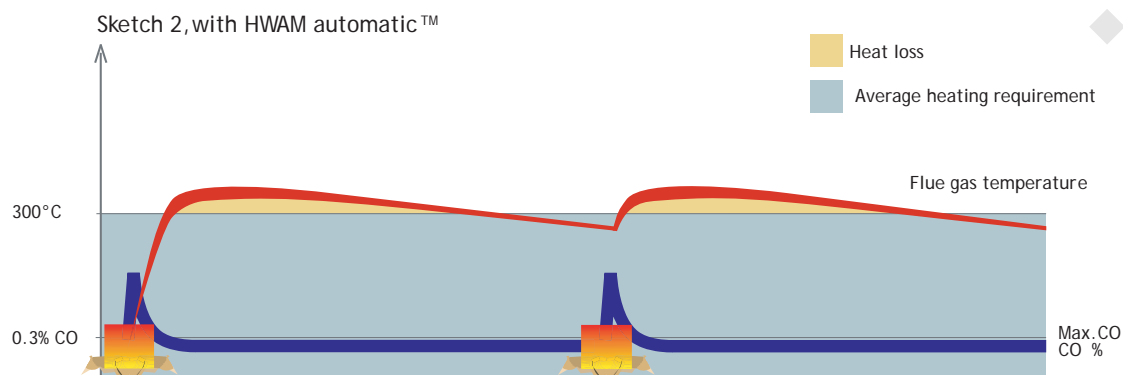
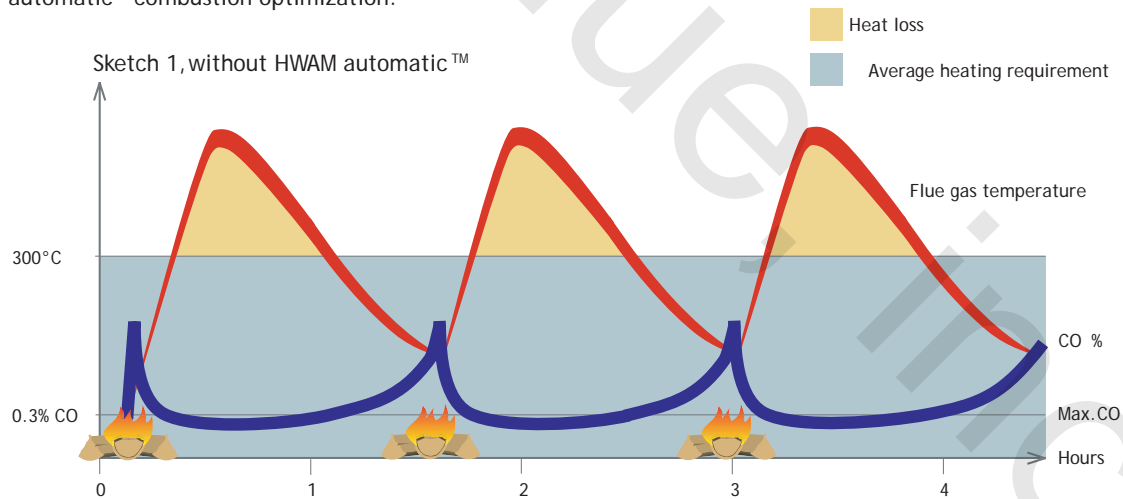

How it works

The thermostatic spring moves the control arm, which regulates the 3 sources of combustion air to maintain a constant temperature in the combustion chamber.

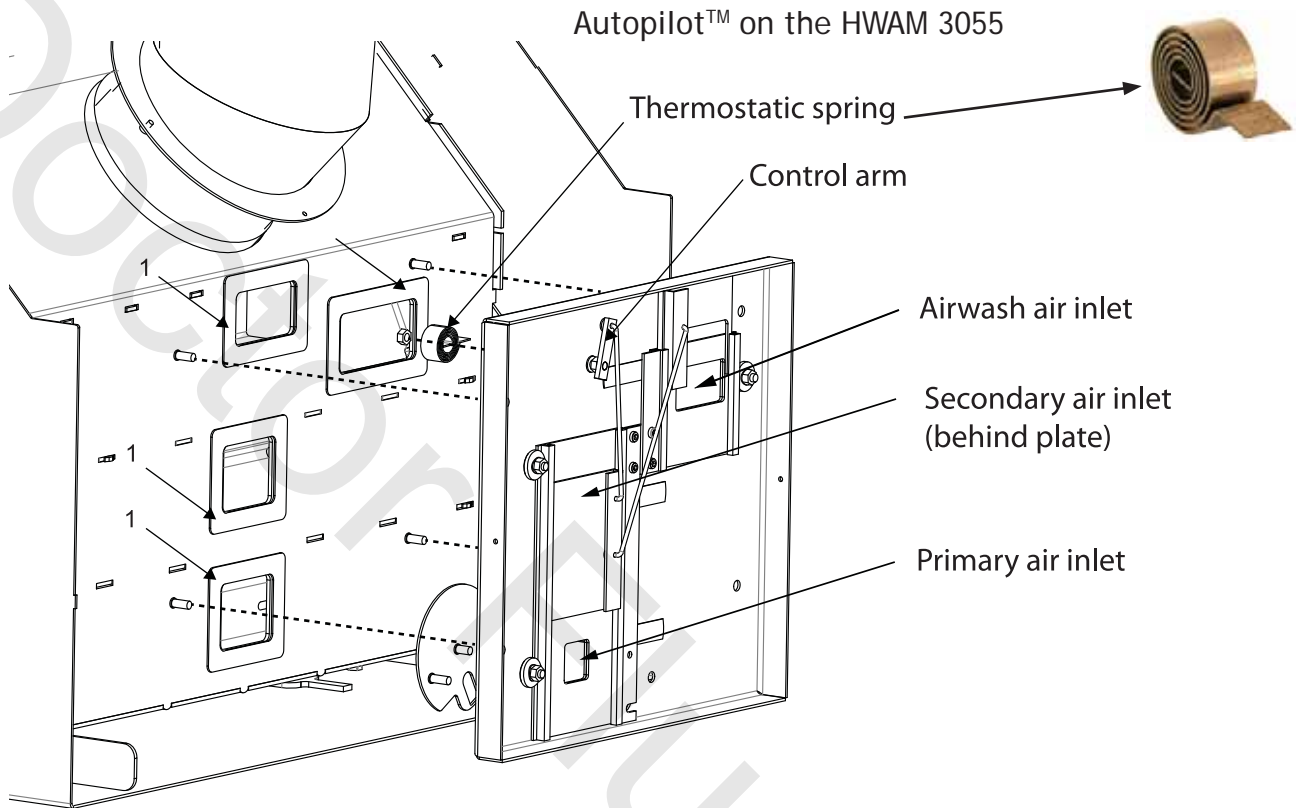

HWAM

3055

Freestanding Wood Fireplace

Clearly inspired by the beautiful flat-screen lines of the HWAM 130 series, design duo Strand + Hvass have created the HWAM 3055 Freestanding wood stove. The Cubist and rather austere expression is softened by slightly rounded corners.



HWAM 3055 Freestanding Wood Fireplace

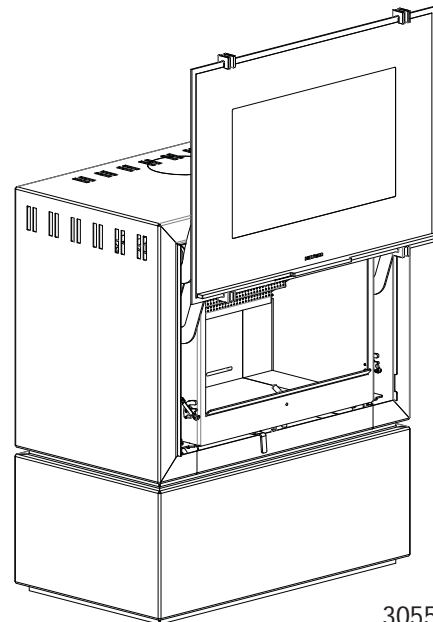
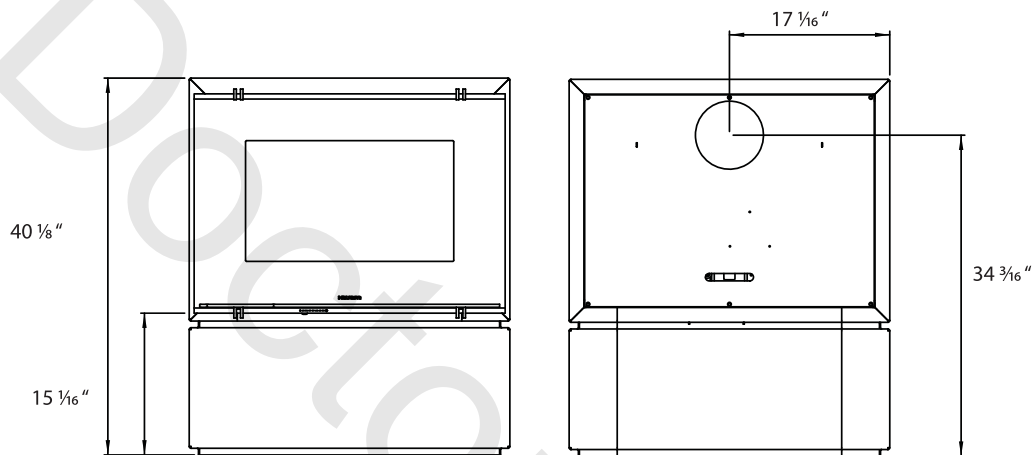

3055
Freestanding
Wood Fireplace
+ Up-swing Door

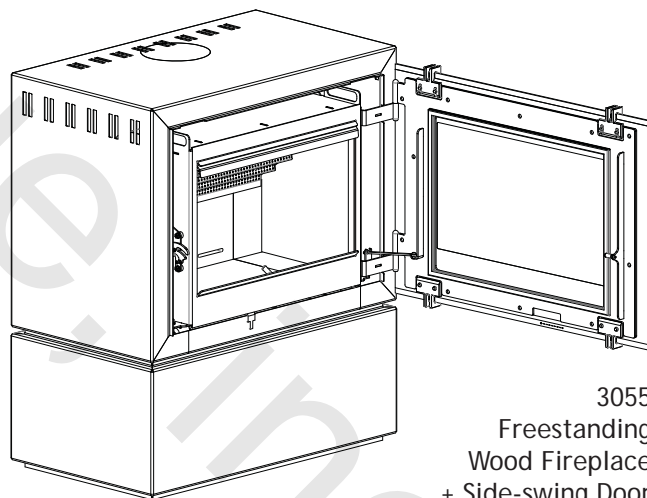
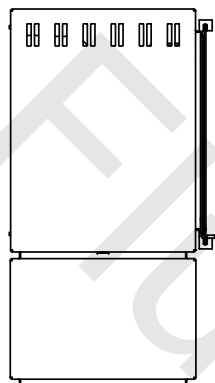
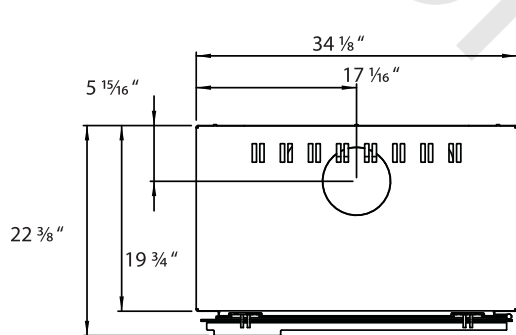

3055
Freestanding
Wood Fireplace
+ Side-swing Door

Technical Specifications

Heat output	13,650 BTU - 34,120 BTU
Average Heat output	23,880 BTU
Flue outlet	6"
Heating capacity	1900 sq.ft.
Efficiency	81%
Weight	265 lbs.
Chimney draft	12 pa
Firebox size	10"h x 22"w x 12.5"D
Firebox volume	2.01 cubic feet
Emissions	US EPA 4.09 g/hr.
Burn time	3-5 hrs.

Approvals

US EPA 4.09 g/hr., ULC S627, UL 1482

Options

Top flue outlet or rear flue outlet, side-swing door or up-swing door, Color: Black or Grey

Features

HWAM Automatic™

HWAM 3055 Insert



The Campbell's Lakeside Lodge, ca. 1920

It has seen kids and dogs and friends swimming and boating in summer; skaters, skiers and intrepid snowshoers in winter. It's been part of the family for years. And, at the center of it rests the fireplace that was built of local stone. Its roaring fires have warmed more than just blue lips and chilled feet; it has given the camp a heart, a place to gather, to share, to laugh, to play.

The HWAM 3055 Insert has just made enjoying that fire safer and cleaner without sacrificing warmth, or the enjoyment of watching an evening's fire burn down into embers.

HWAM 3055 Insert



Technical Specifications

Heat output	13,700-34,000 BTU
Average heat output	20,500 BTU
Flue outlet	6"
Heating capacity	1900 sft.
Efficiency	81%
Weight	216 lbs.
Chimney draft	12 Pa
Firebox size	10" h x 22" w x 12.5" d
Firebox volume	2.01 cubic feet
Emissions	US EPS 4.09 g/hr.
Wall clearance	8" to side
Burn time	3-5 hrs.

Options

Fresh air system
Color: Black

Features

HWAM Automatic™

Fireplace *Inserts* - are designed to be installed in existing, code approved, wood-burning fireplaces. The insert is a retrofit for existing fireplaces - the zero clearance is not. An optional HWAM trim kit is available to close the gap between the insert and the existing fireplace opening.

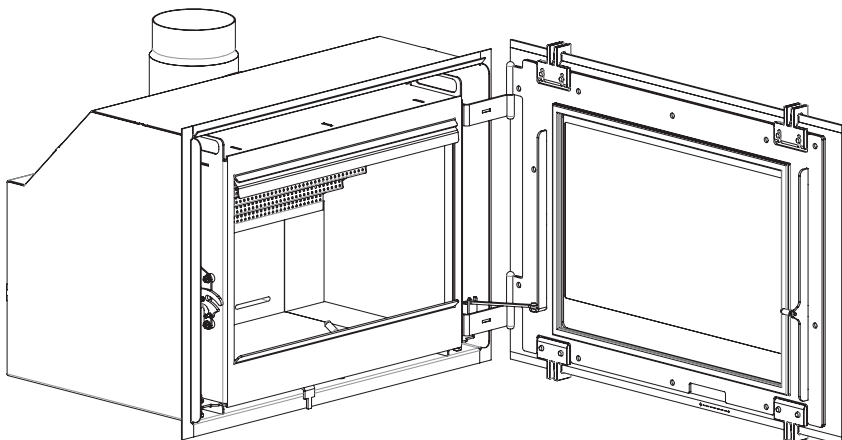
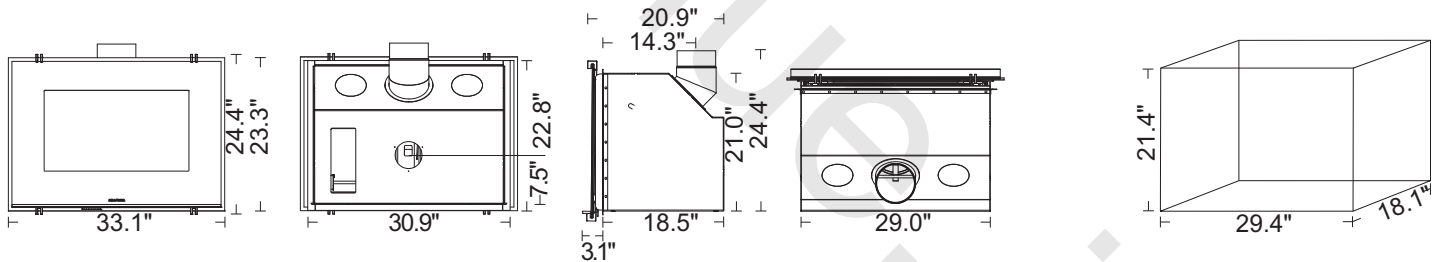

3055 Wood-burning Insert
+ Side-swing Door

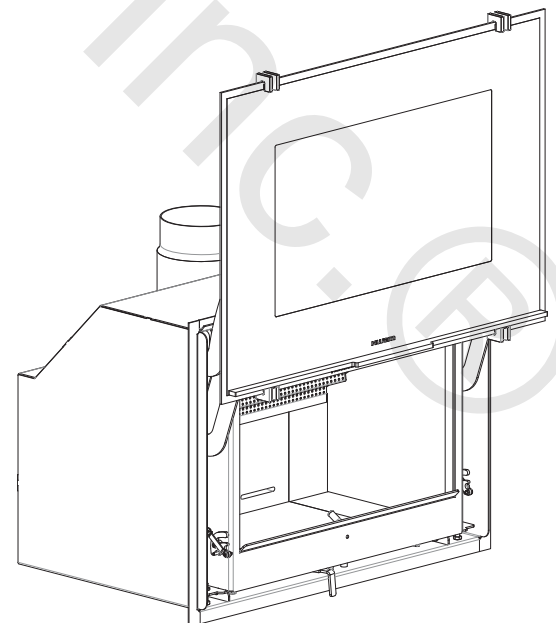

3055 Wood-burning Insert
+ Up-swing Door

HWAM

3055 Zero Clearance



Architect designed, elegant and functional, HWAM's 3055 Zero Clearance Fireplace features an all-glass upswing door with a large, clear-view window trimmed in basic black. A slim, handle beam is unobtrusively anchored to the door's lower edge, so with a gentle lift of the handle the door glides up and away in one smooth motion.

HWAM 3055 Zero Clearance



Technical Specifications

Heat output	13,700-34,000 BTU
Average heat output	20,500 BTU
Flue outlet	6"
Heating capacity	1900 sft.
Efficiency	81%
Weight	216 lbs.
Chimney draft	12 Pa
Firebox size	10" h x 22" w x 12.5" d
Firebox volume	2.01 cubic feet
Emissions	US EPS 4.09 g/hr.
Wall clearance	8" to side
Burn time	3-5 hrs.

Options

- Fresh air system
- Color: Black

Features

HWAM Automatic™

Zero Clearance fireplaces - are designed to be installed during new home construction, or during renovation. The Zero Clearance must be installed with a UL or ULC approved high-temperature, factory-built chimney. Zero clearance fireplaces do not require a trim kit.

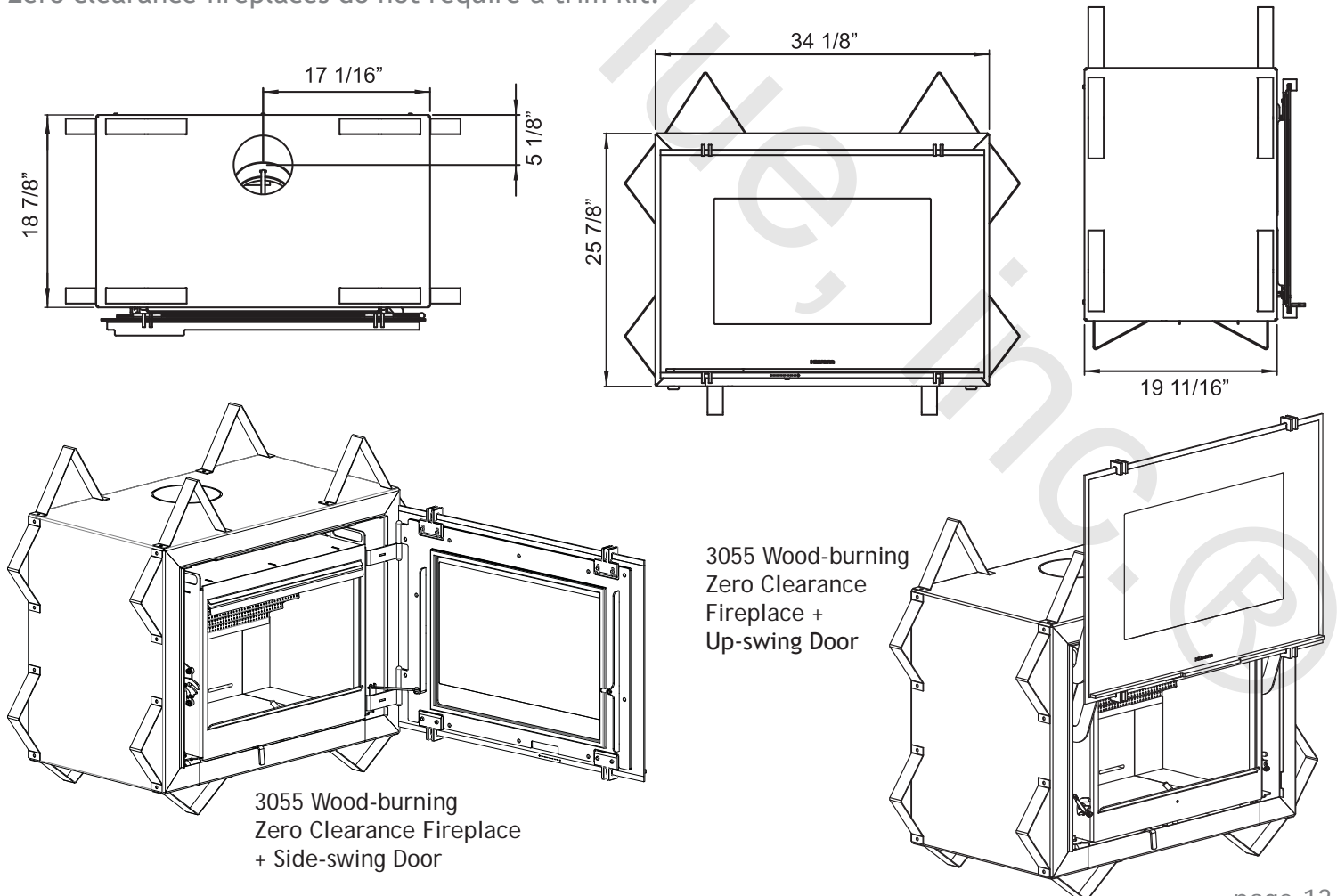

3055 Wood-burning
Zero Clearance Fireplace
+ Side-swing Door

3055 Wood-burning
Zero Clearance
Fireplace +
Up-swing Door

Hwam 3055 Zero Clearance Fireplace



Shown with optional soapstone hearth and 8-inch surround



Shown with optional Angola Black Granite hearth and 4-inch surround

Hwam

Monet

The curved panoramic glass front and the spacious sunken combustion chamber are placed at a practical height, which makes it easy to light the stove and enjoy the flames.



Designer: Architect Anders C. Fasterholdt

The Vertical orientation of the Monet and the small footprint give you great flexibility in where to place the stove. It can be placed near the connection between two rooms where it can be seen from both. The large viewing area and curved glass allow the flames to be seen from a wide angle. The Monet can be installed 6" to a combustible wall. This means it will not project as far into possible travel paths.

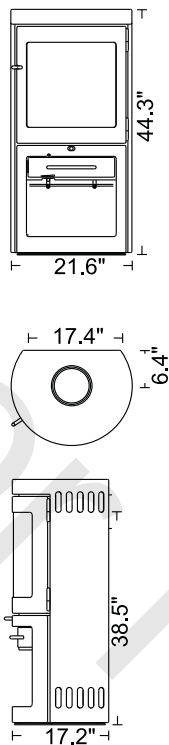

Monet + soapstone and woodbox, grey

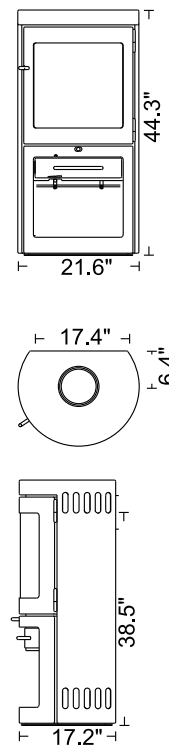

Monet + woodbox, black

HWAM *Monet*

Technical Specifications

Heat output	10,200-27,300 BTU
Average heat output	20,500 BTU
Flue outlet	6"
Heating capacity	1600 sft.
Efficiency	81%
Weight	324 - 331 lbs.
Weight w. soapstone	540 - 547 lbs.
Chimney draft	12 Pa
Connec. from floor, rear	38.5"
Connec. from floor, top	42.4"
Firebox size	15"h x 15"w x 10"d

Options

- Top flue outlet or rear flue outlet
- Drawer or wood section
- Fresh air system
- Soapstone sides with top/rear flue outlet
- Soapstone top with top/rear flue outlet
- Color: Black or Grey

Features

HWAM Automatic™

Approvals

UL 1482 ULC C627 EPA Emissions 3.4 g/hr.



Monet H + soapstone, oven, and drawer, grey

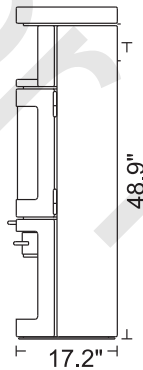
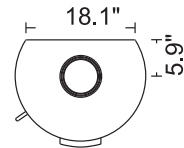
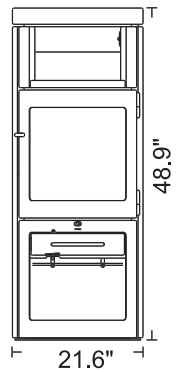

Monet H + oven and woodbox, black

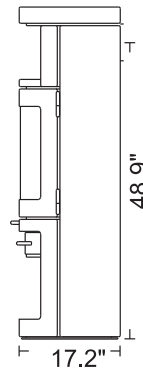
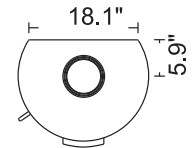
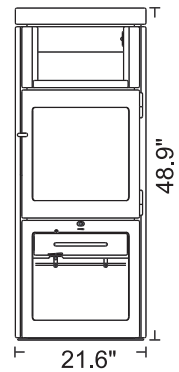

HWAM *Monet H*

Technical Specifications

Heat output	10,200-27,300 BTU
Average heat output	20,500 BTU
Flue outlet	6"
Heating capacity	1600 sft.
Efficiency	81%
Weight	390 - 397 lbs.
Weight w. soapstone	644 - 650 lbs.
Chimney draft	12 Pa
Connec. from floor, rear	48.9"
Connec. from floor, top	52.9"
Firebox size	15" h x 15" w x 10" d
Oven size	9.75" h x 14.0" w x 7.5" d

Options

- Top flue outlet or rear flue outlet
- Drawer or wood section
- Fresh air system
- Soapstone sides with top/rear flue outlet
- Soapstone top with top/rear flue outlet
- Baking section
- Color: Black or Grey

Features

HWAM Automatic™

Approvals

UL 1482 ULC C627 EPA Emissions 3.4 g/hr.

Impressive in size and performance, a visual draw in any room, the Classic 7 possesses the largest heating capacity of all HWAM stoves; and, yes, you can bake Santa's cookies in it. Or pizza, roasted squab, bruschetta, cornbread, baked beans...

Design: Architect Anders C. FASTERHOLDT



HWAM
Classic 7

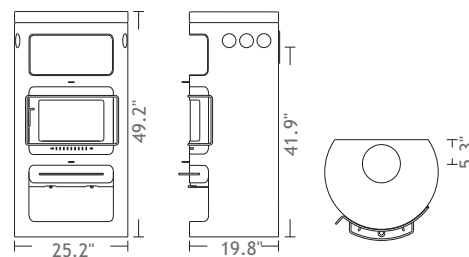
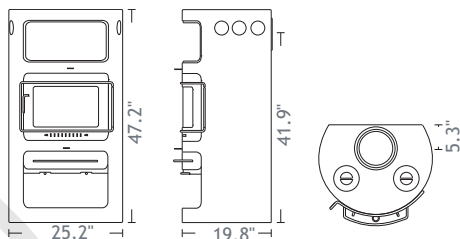

HWAM *Classic 7*

Technical Specifications

Heat output	27,300-48,800 BTU
Average heat output	37,600 BTU
Flue outlet	6"
Heating capacity	2800 sft.
Efficiency	79%
Weight	405 lbs.
Weight w. soapstone top	483 lbs.
Chimney draft	12 Pa
Connec. from floor, rear	41.9"
Connec. from floor, top	45.9"
Firebox size	13"h x 18"w x 15"d
Oven size	10"h x 18.5"w x 10"d

Options

- Top flue outlet or rear flue outlet
- Soapstone top with top/rear flue outlet
- Color: Black or Grey

Features

HWAM Automatic™

Approvals

UL 1482 ULC C627

Emissions: Qualifies as an EPA exempt cookstove

Doctor's Heating & Air Conditioning, Inc.®

HWAM North America

211 Reservoir Rd.

Plymouth, New Hampshire 03264

www.HWAMna.com

TEL: 603-236-7045

FAX: 866-830-5719

E-mail: hearth@HWAMna.com

