

The Klassik



WITTUS
FIRE BY DESIGN

The Klassic

The original Klassic stove fireplace was first developed in 1970 by the renowned Danish industrial designer Bent Falk. His goal was to provide clients with a modern fireplace that could also provide efficient heating. The initial concept was based on the antique stoves from Europe that had multiple functional compartments such as raised fireboxes, convenient wood storage beneath the fire, and also a baking and cooking oven above the firebox.

Bent Falk's new stove fireplace design and technology revolutionized the industry and it has since become the model for all contemporary stove designs throughout Europe.



Wittus first brought these Klassic stoves to the United States in the late seventies and today, these technically updated unique stoves are proudly made in the USA under the supervision and guidance of Bent Falk by skilled, educated steel fabricators using American steel and ingenuity for a truly handcrafted quality product.

The heart of each stove is a large modern EPA approved firebox with a self cleaning glass door that easily accommodates standard log sizes up to 24" in length.

Each Klassic stove is built from heavy gauge 1/4" plate steel using laser guided machines for optimum precision. The plates are then riveted together to form the outer shells.

Signature Bent Falk Klassic style of exposed rivets and clean lines are apparent throughout the design, and even the back of the stove has details that allow the unit to be free standing and enjoyed from all sides.

Each of the heavy double steel doors comes standard with stainless steel handles and inner back panels, which can be optionally painted in black or a variety of exciting colors to match your particular décor. (Samples of the star door panels in red, yellow, green, orange, and blue at right).

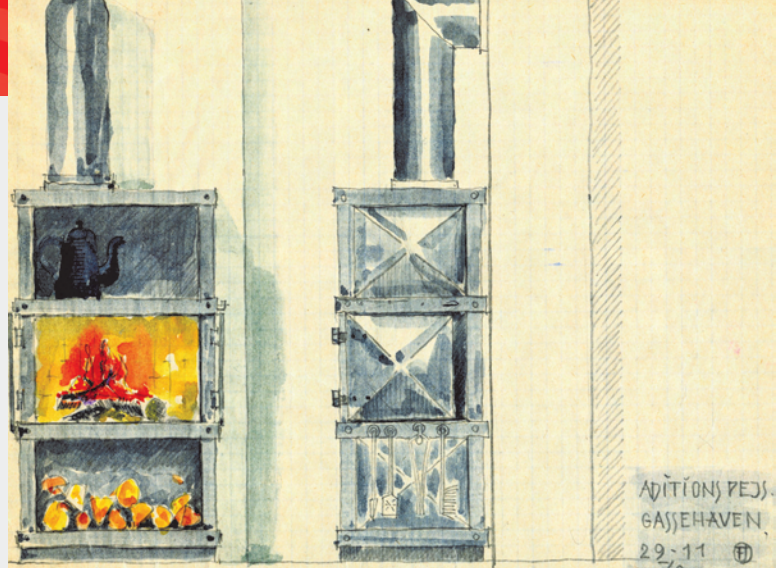

The Klassic



The upper compartment can easily become a convenient baking or roasting oven by flipping the two louver handles at the back top (shown at far left below) to close the louver vents.

The oven area comes with a thermometer and a natural 2" thick Brazilian soapstone baking liner for heat retention and consistent even baking. The firebox doors can be closed to further increase the oven temperature.

Also, with the doors closed, "peek" through the stainless steel laser cut openings to see the fire glow, or fold them back conveniently flat on each side of the stove to watch a panorama of exciting flames.

Bold and robust is the essence of these unique contemporary fireplace/stoves and the attention to detail is a must.

The "stars" that have been incorporated into every unit are a testimonial for "Made in USA" by skilled craftspeople.



The door hinges (shown at near left) are made so that when the doors are fully open, they fold flat against the side of the unit, exposing a unique view of the back panels and integral to the total design.

Experience and enjoy!

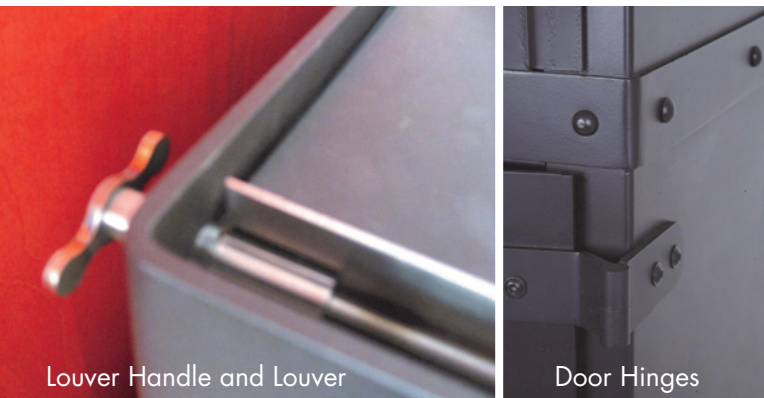

Louver Handle and Louver

Door Hinges

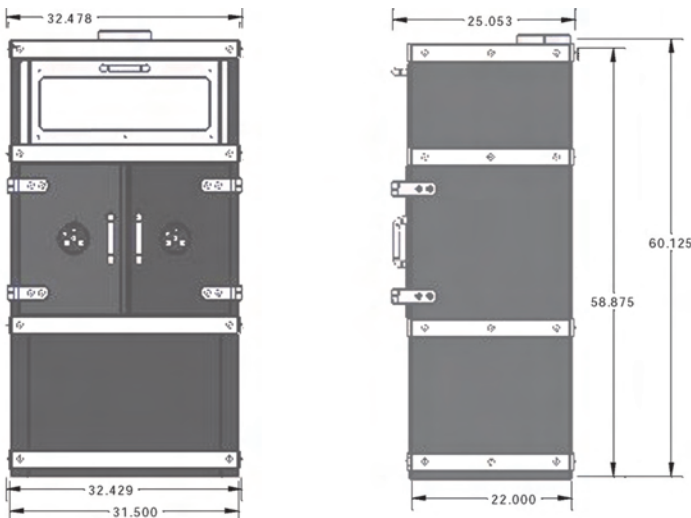

Technical Specifications

Color/Material	Matte Black Steel	
Heat output range	14-45kBTU	4-13kW
Approx. heating area	600-1,500ft ²	
Flue size	6"	15cm
Venting	Top	
Weight	520lb	235kg
Dimensions: h/w/d	60/32/25"	152/81/64cm
Firebox: h/w/d	14/24/12"	35/60/30cm

WITTUS
FIRE BY DESIGN



Wittus Inc.
P.O. Box 120
Pound Ridge NY 10576
T 914.764.5679
F 914.764.0465
www.wittus.com
info@wittus.com

© Wittus Inc. 2010